

# FLYWAY BARRIER EXAMPLE

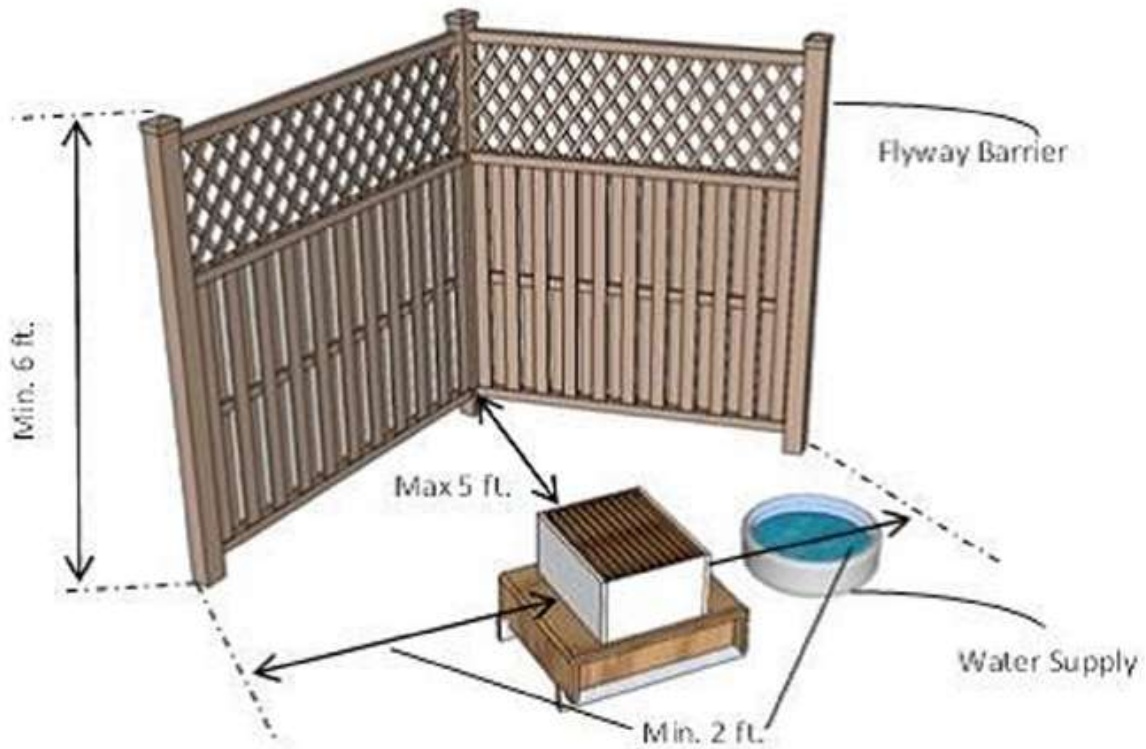

- A solid fence or dense hedge, known as a “flyway barrier”, at least six (6) feet in height, shall be placed along the side of the beehive that contains the entrance to the hive, and shall be located within five (5) feet of the hive and shall extend at least two (2) feet on either side of the hive. A flyway barrier shall be required if all beehives are located at least twenty-five (25) feet from all property lines.

- A Flyway Barrier is an obstacle like a fence, wall, or vegetation used to force bees to fly upwards when they leave the hive to avoid contact with people and reduce the risk of stinging.

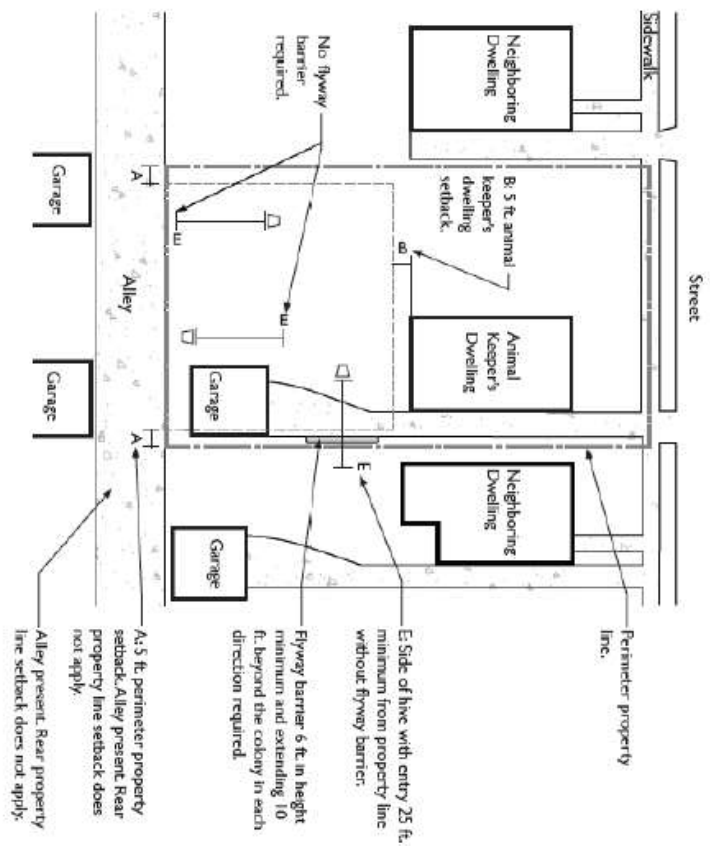

Perimeter property line.

E Side of hive with entry 25 ft. minimum from property line without flyway barrier.

Flyway barrier 6 ft. in height minimum and extending 10 ft. beyond the colony in each direction required.

A: 5 ft. perimeter property setback. Alley present. Rear property line setback does not apply.

Alley present. Rear property line setback does not apply.

**Legend**

- Perimeter Property Line
- Perimeter Property Line & Bee Keeper's Dwelling Setback Line
- 5 ft. Perimeter Property Line Setback
- 5 ft. Bee Keeper's Dwelling Setback
- 25 ft. Beehive Entry Perimeter Property Line Setback
- Beehive
- Flyway Barrier (6 ft. in height min & extending 10 ft. beyond the colony in each direction)

**EXAMPLES:**

